



Taking a Quiz

The quizzes tool is where you will go to access and take quizzes and/or exams for your online course.

CHROMEBOOK USERS: If the instructor is using LockDown Browser pop-ups MUST be allowed or enabled in Chrome otherwise you may get stuck on the "Start Quiz" page ([how to enable pop-ups in Chrome](#)).

IPAD USERS: if the instructor set the option for ipads to be used when taking a quiz/exam view skip to page 10.

Accessing a Quiz

1. Click Assessments (1) and click on Quizzes in the navbar (2).

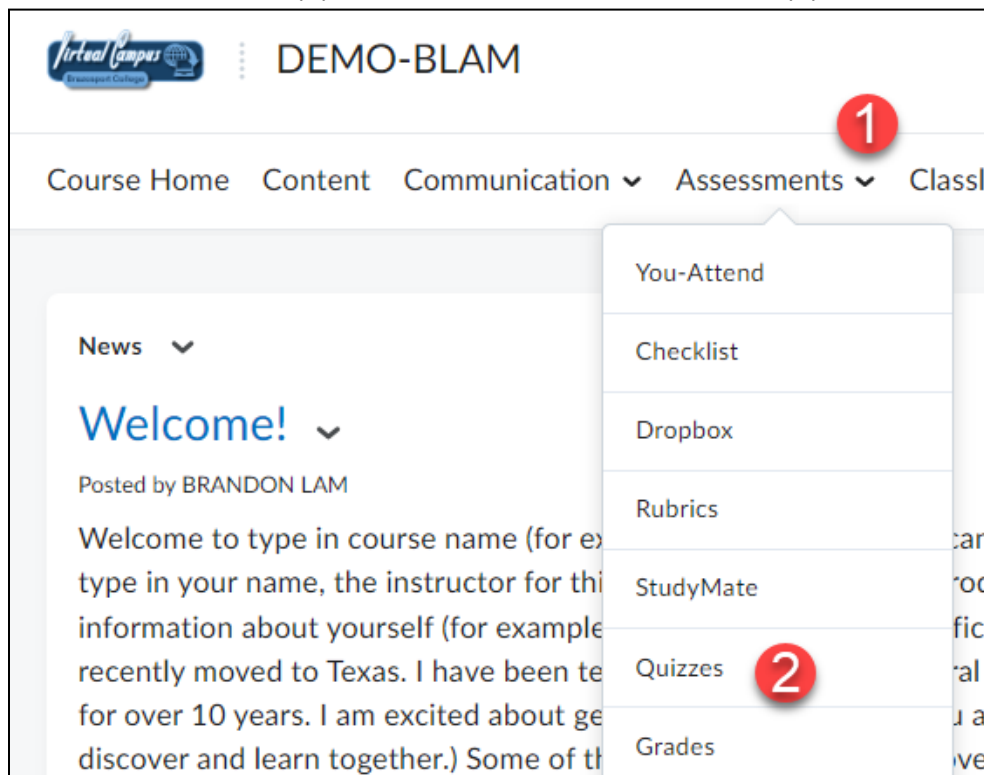

2. Click on an available quiz title in the Quiz List.

The screenshot shows the 'Online Course Tools Tour' page. At the top, there is a navigation bar with 'Course Home', 'Content', 'Communication', 'Assessments', 'Classlist', and 'Glossary'. Below this is the 'Quiz List' section. The first quiz listed is 'Without Category', which is highlighted in light blue. A red arrow points to this title. Below it are three other quizzes: 'Monitor Quiz Test - Requires Respondus LockDown Browser + Webcam', 'Exam 3- Requires Respondus LockDown Browser', and 'Test for marking as a zero'. Each quiz entry includes its availability date and time.

3. Information under the quiz title (on the left) indicates the availability date and Attempts (on the right) show how many times you can take the quiz.

This close-up shows the 'Test for marking as a zero' quiz entry. On the left, the text 'Available on Mar 18, 2021 11:37 AM' is displayed, with a red arrow pointing to it. On the right, the text '0 / 1' is displayed, with a red arrow pointing to it.

Starting a Quiz

1. Once you click on a quiz, carefully read quiz Description, Details and Instructions. **Click** Start Quiz button to begin quiz.

[Quiz List](#) > [Summary](#)

Summary - Week 1 Quiz 1 ▾

Quiz Details

Current Time
10:06 AM [Update](#)

Current User
BRANDON LAM (username: BLAM)

Quiz Period
Due on Mar 30, 2020 11:00 PM

Time Limit
No time limit (estimated time required: 120 minutes)

Attempts
Allowed - 5, Completed - 1

Instructions

Before you submit the quiz, you will have the opportunity to return to questions that you may have missed or have not yet answered. You can submit your quiz responses at any time.

Click "Start Quiz" to begin Attempt 2.

[Start Quiz!](#) 

Depending on how the instructor set up the quiz, questions will be presented one at a time and you must click the Next button to move forward OR questions will be presented all at once.

2. Select the radio button(s) or checkboxes for the response(s) you believe to be the correct answer for each question. Some questions may have you enter a text response.

BRANDON LAM: Attempt 1

Page 1:

1 2 3
-- -- --

4 5 6
-- -- --

7
--

Test 1

Question 1 (1 point)
I am human

True
 False

Question 2 (1 point)
My dog is a dog

True
 False

Question 3 (1 point)
My cat is an animal

True
 False

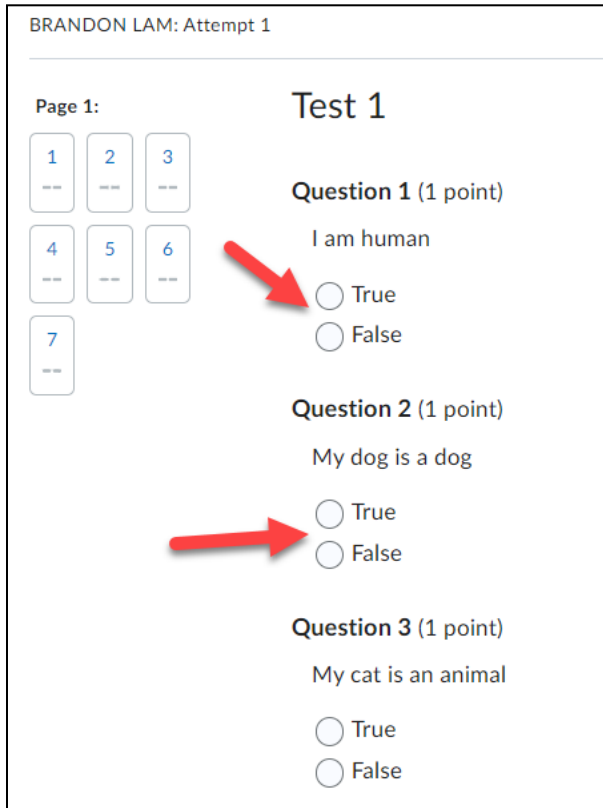

3. When you select a response for a question, your answer will automatically be saved as indicated by the checkmark under the question number in the Quiz Info area on the left and next to the question number to the right.

Page 1:

1 2 3
✓ -- --

4 5 6
-- -- --

7
--

Test 1

Question 1 (1 point) ✓ *Saved*
I am human

True
 False

Question 2 (1 point)

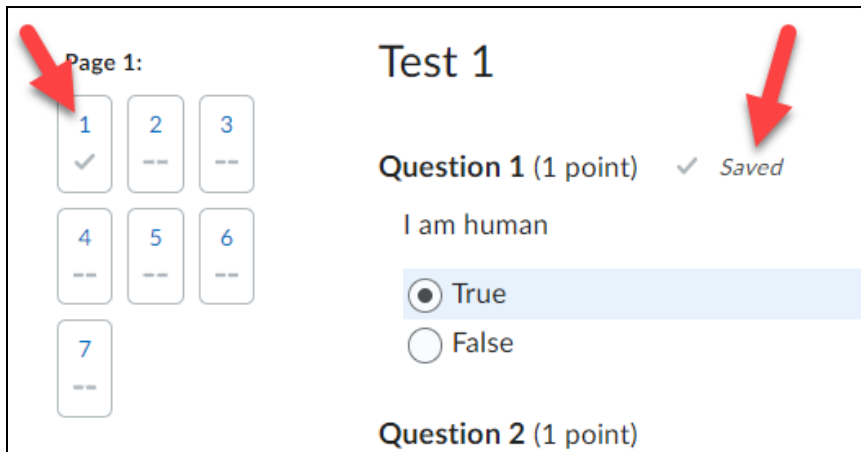

4. Once done answering all questions **click** on the Submit Quiz button.

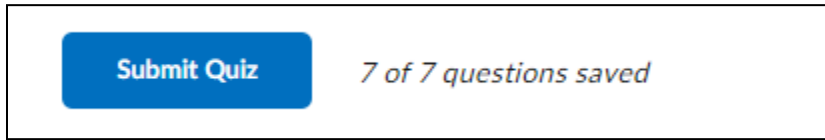

5. **Confirm** ALL questions have been saved and **click** the Submit Quiz button.

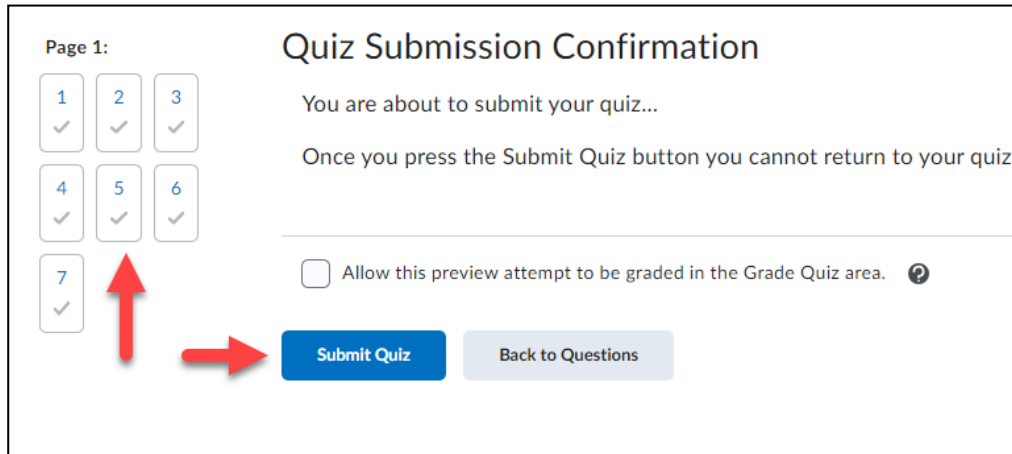

6. Depending on how the instructor set up the course, you can view the Score and Overall Feedback immediately on submission.



7. To view question specific feedback (if Feedback is provided), **click** on the View Feedback link under each question.

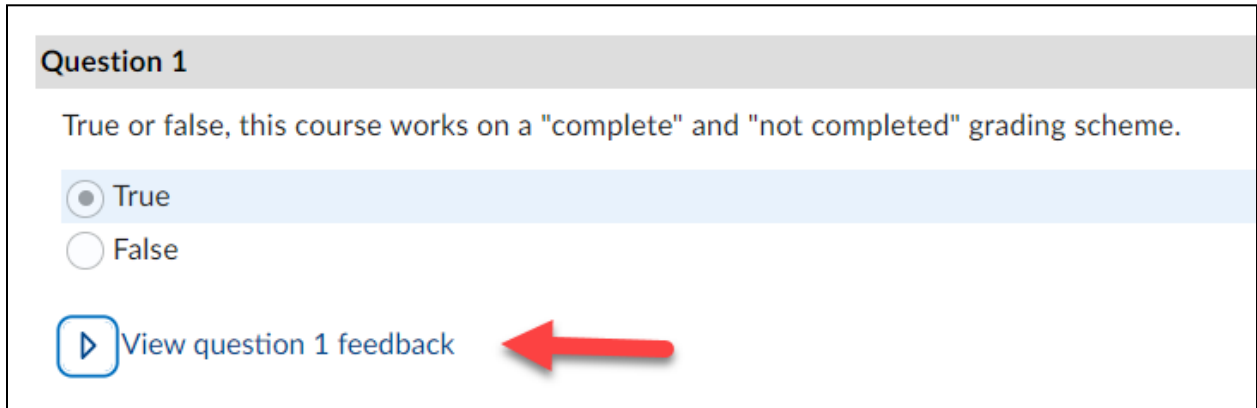

If the instructor specified feedback will be viewable later, return to Submissions by going to Assessments in the course navbar and selecting Quizzes, then **click** on the down-ward facing triangle next to the quiz in the Quiz List and click on the Submissions icon.

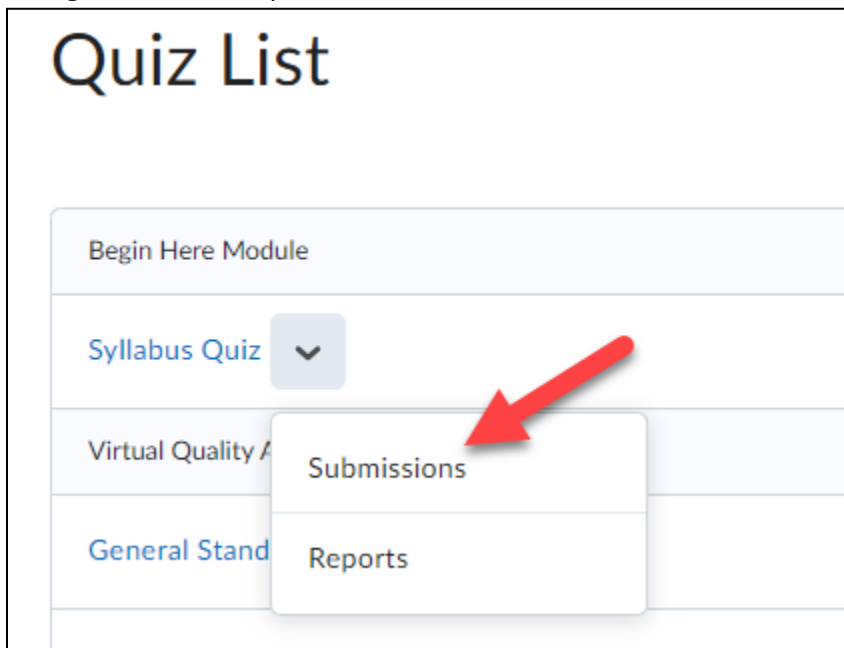

Respondus LockDown Browser

Some instructors require quizzes to be taken using the Respondus LockDown Browser and/or Monitor. The LockDown Browser disables the ability to print, copy, go to another website, or access other applications. You will be locked into the quiz until you submit it for grading.

To start a quiz that has LockDown Browser enabled:

1. Enter the Quizzes section in D2L (using your regular internet browser).

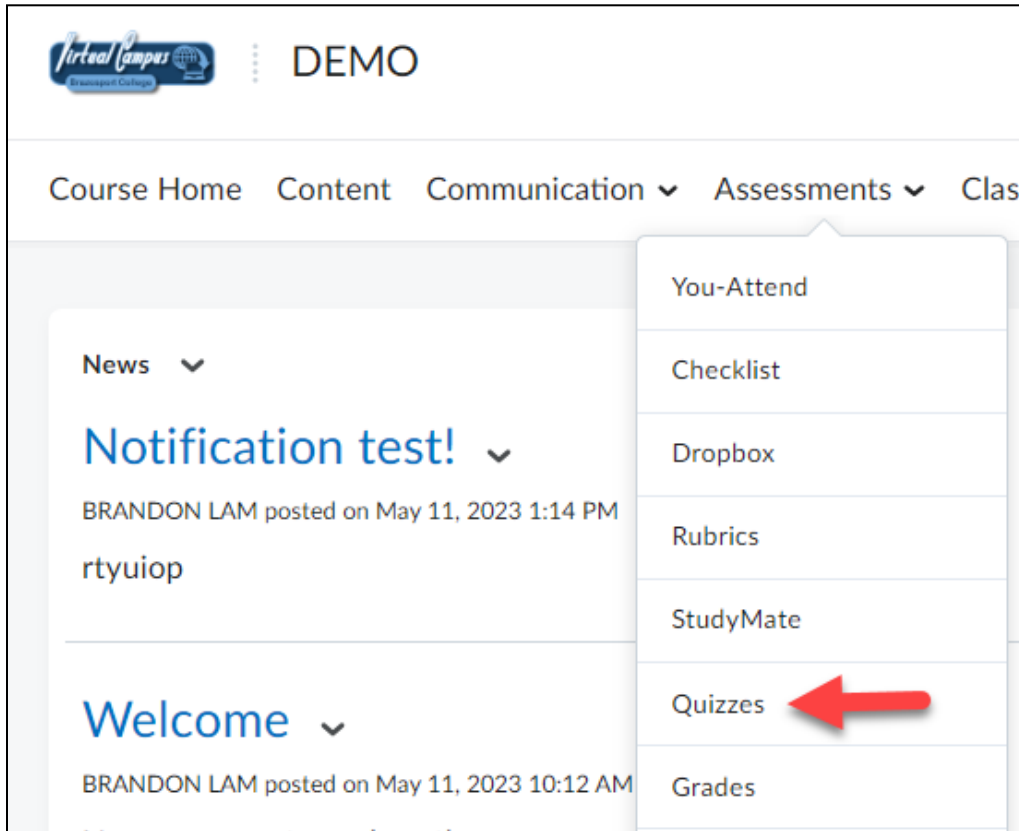

2. Click on the Quiz.

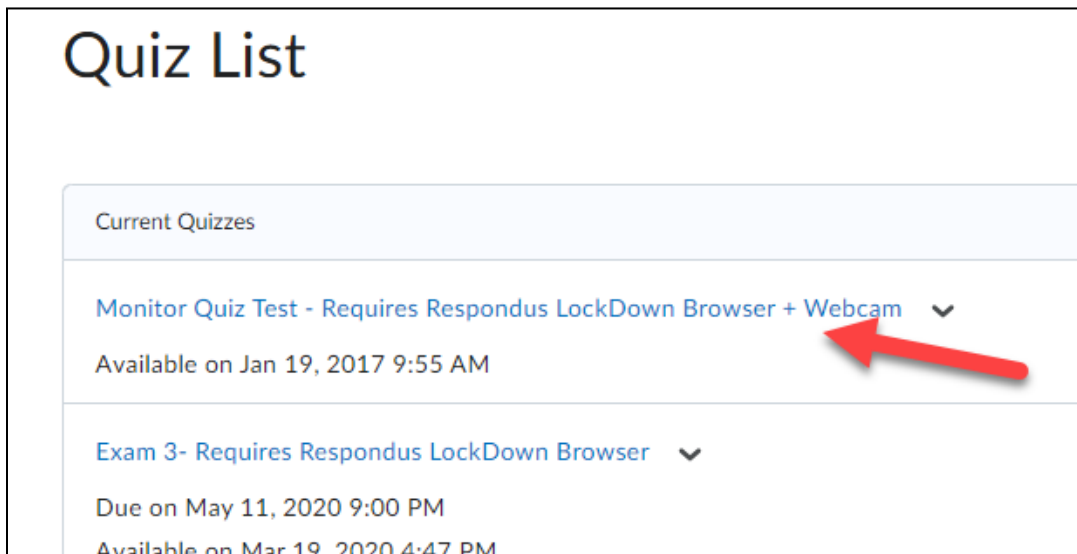

3. Click on the blue Download and install the latest version of LockDown Browser link.

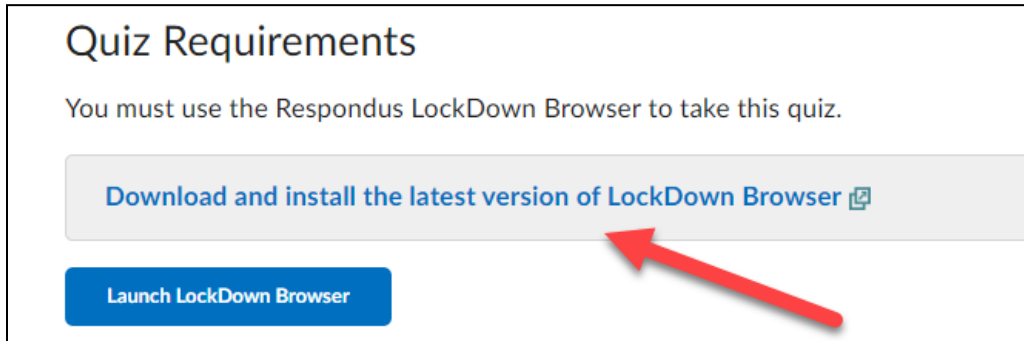

Quiz Requirements

You must use the Respondus LockDown Browser to take this quiz.

[Download and install the latest version of LockDown Browser](#) 

[Launch LockDown Browser](#)

A red arrow points to the blue link text.

4. Click on the Install Now button.

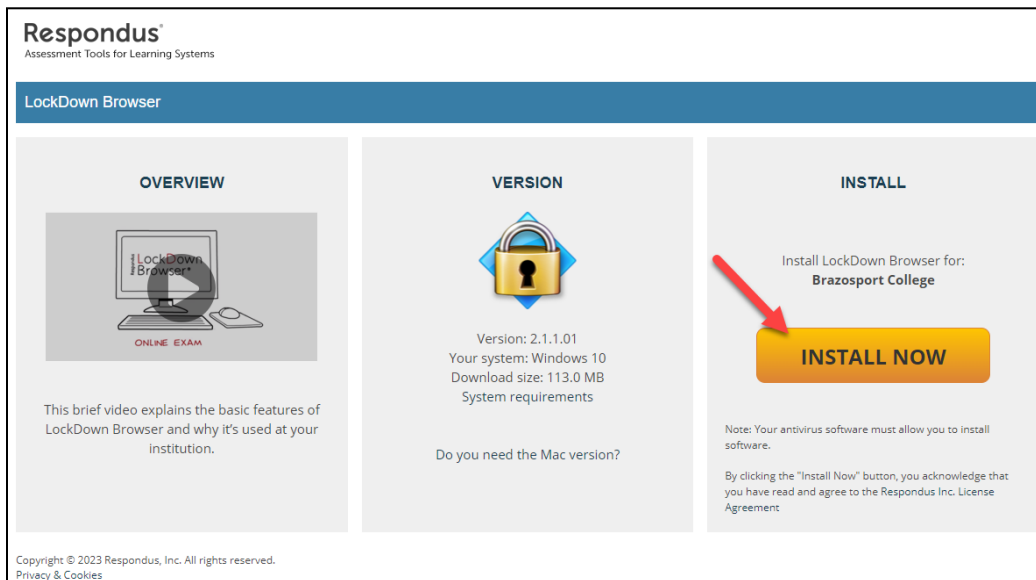

Respondus
Assessment Tools for Learning Systems

LockDown Browser

OVERVIEW



ONLINE EXAM

This brief video explains the basic features of LockDown Browser and why it's used at your institution.

VERSION



Version: 2.1.1.01
Your system: Windows 10
Download size: 113.0 MB
System requirements

Do you need the Mac version?

INSTALL

Install LockDown Browser for:
Brazosport College

[INSTALL NOW](#)

Note: Your antivirus software must allow you to install software.

By clicking the "Install Now" button, you acknowledge that you have read and agree to the Respondus Inc. License Agreement.

Copyright © 2023 Respondus, Inc. All rights reserved.
Privacy & Cookies

A red arrow points to the yellow 'INSTALL NOW' button.

5. The browser will begin downloading on your computer as LockDownBrowser....exe.



6. Once the browser is done downloading, **click** on it **(1)** and then **click** Open **(2)**.

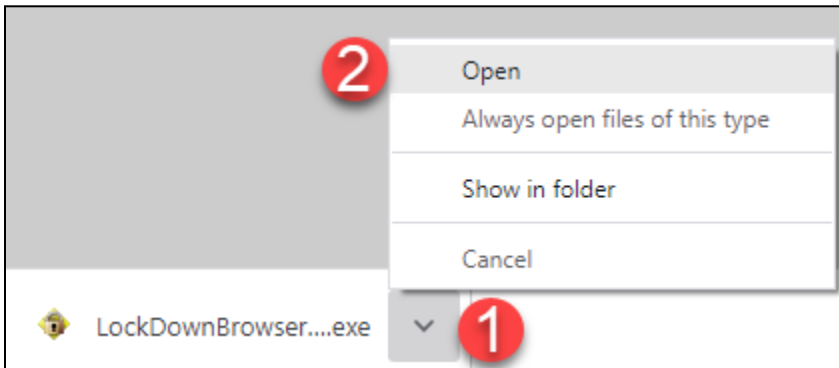

7. When successfully downloaded the LockDown Browser icon will appear on your desktop.



8. You can now return to the quiz and click on the "Launch Lockdown Browser" button and start the quiz.

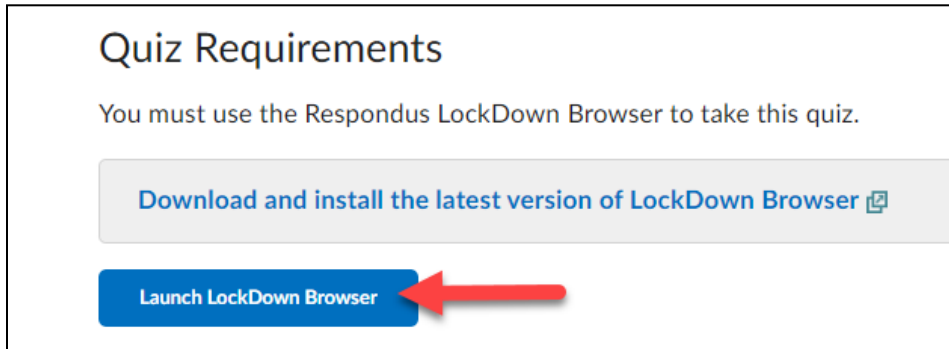

NOTE: If you will be using an iPad to take a quiz that requires Lockdown Browser and Monitor, please make sure to follow these recommendations:

iPad LockDown Browser Guide

1. Download and install the "LockDown Browser" app from the Apple App Store to the iPad. (Requires iOS 11 or higher.)
2. Open your mobile browser (Safari, Chrome, etc.), log into your learning system, and navigate to the quiz. Start the quiz; the LockDown Browser app will automatically launch.
3. When you start a quiz that requires LockDown Browser, you should see the following message. You must **click** "Yes" to open the LockDown Browser app.

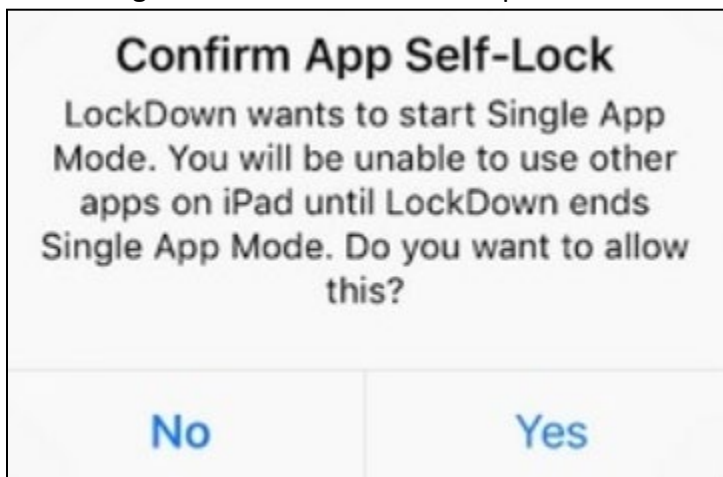

4. Once you **click** "Yes" to confirm "app self-lock," you will see a message confirming that your iPad is now locked to LockDown Browser.

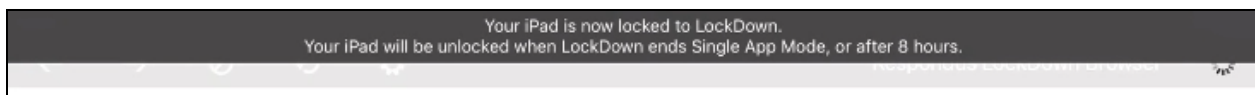

5. After you submit the exam, you'll see confirmation that your iPad is no longer locked to LockDown Browser.

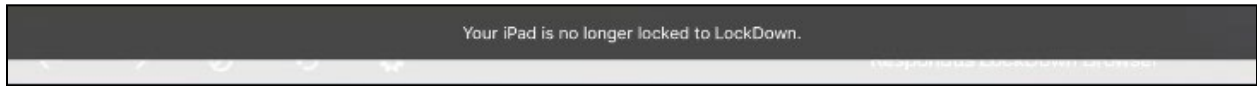

6. You can now either take another exam, or exit the LockDown Browser app.

NOTE: It's important that you don't start Apple's Guided Access feature (by triple clicking the home button) and then enter LockDown Browser. If you do, you'll see this warning message at the top of LockDown Browser.

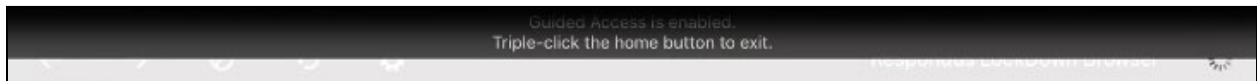

You should immediately triple click the home button and exit Guided Access before proceeding with your exam. If you do not, you'll see this error message when trying to start your exam:

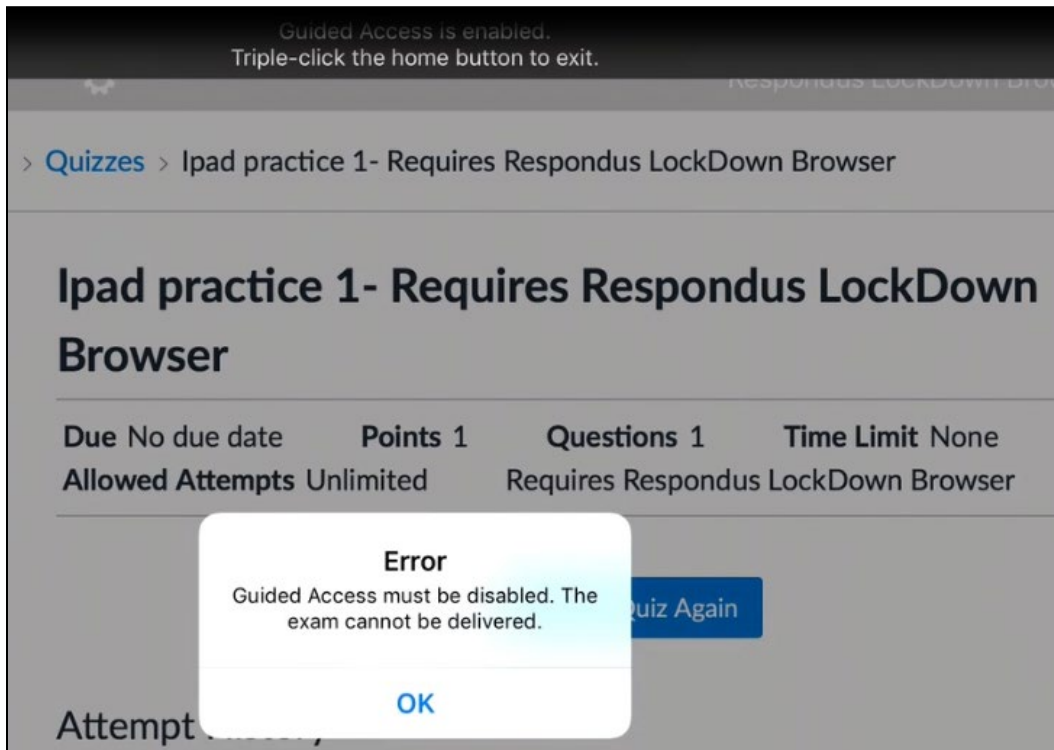

You can permanently disable Guided Access on your iPad by going to "settings">"general">"accessibility">"guided access".

To view Scoring Details on a Submitted Quiz

This capability is only available if instructor enabled quiz to be reviewed in this manner.

1. Click on Assessments and select your "Progress".

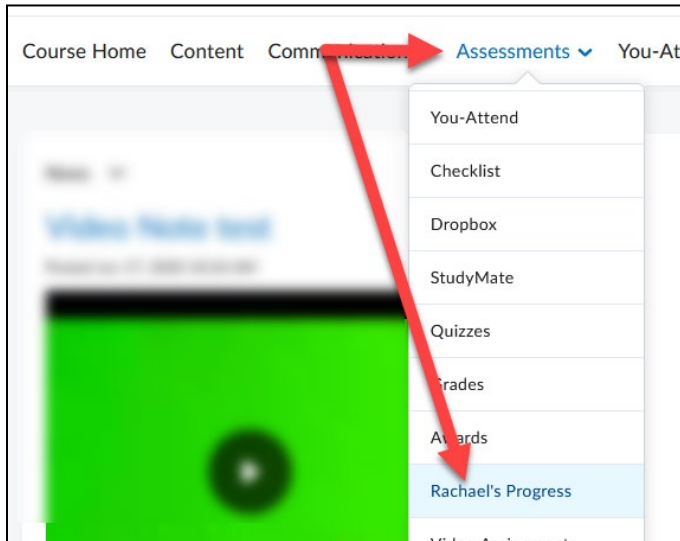

2. Use Table of Contents on left of page and click Quizzes, under a specific quiz on the right, click Details.

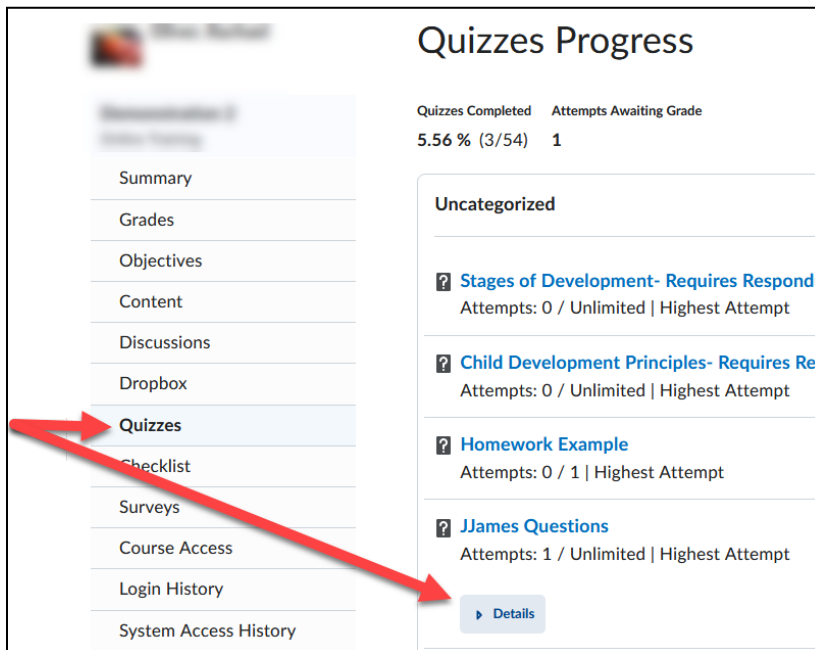

3. Under Details select "Attempt 1" to reenter submitted quiz and view specific results.

